

Artimax™ FOREDOM® Typhoon® Carbide Burs

Model Grinding

Ideal for use on **Artimax™** articulators (Quad & Full arch)
Make your model work look GREAT!!!



Lingual

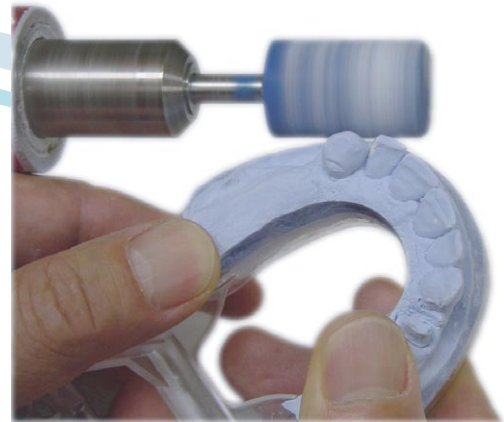

Buccal



Mesio-buccal



Distal

Actual size

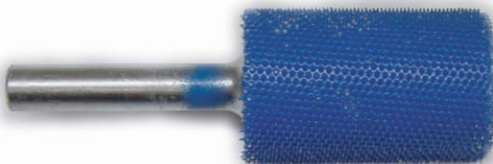

1/4" Shank
Fine Cylinder
13/16" Head Dia.
1 1/4" Head Length



Say good bye to your arbor bands...

Unique structurally aligned tungsten carbide burs grind die stone without clogging and last almost indefinitely. They leave a smooth finish and do not clog up with die stone or epoxy material. Any residue can be cleaned off the bur with a brass wire brush or 5-10 seconds under a steam cleaner.

17⁹⁵ each

Lowest Price Guaranteed!!!

Call now 800-255-2839

Artimax™ Gold Titanium Lathe Bur

Model
Grinding

Ideal for use on Artimax™ articulators (Quad & Full arch)
Make your model work look GREAT!!!



1/4" Shank, 1/2" Diameter bur

Actual size

A top quality tungsten bur with a unique permanent 0.001 gold-colored titanium nitride coating assures a faster, smoother finish



Faster... Smoother... model finishing



Mesio-buccal



Lingual



Distal

36⁹⁵ each

Call now 800-255-2839

Before grinding

After grinding

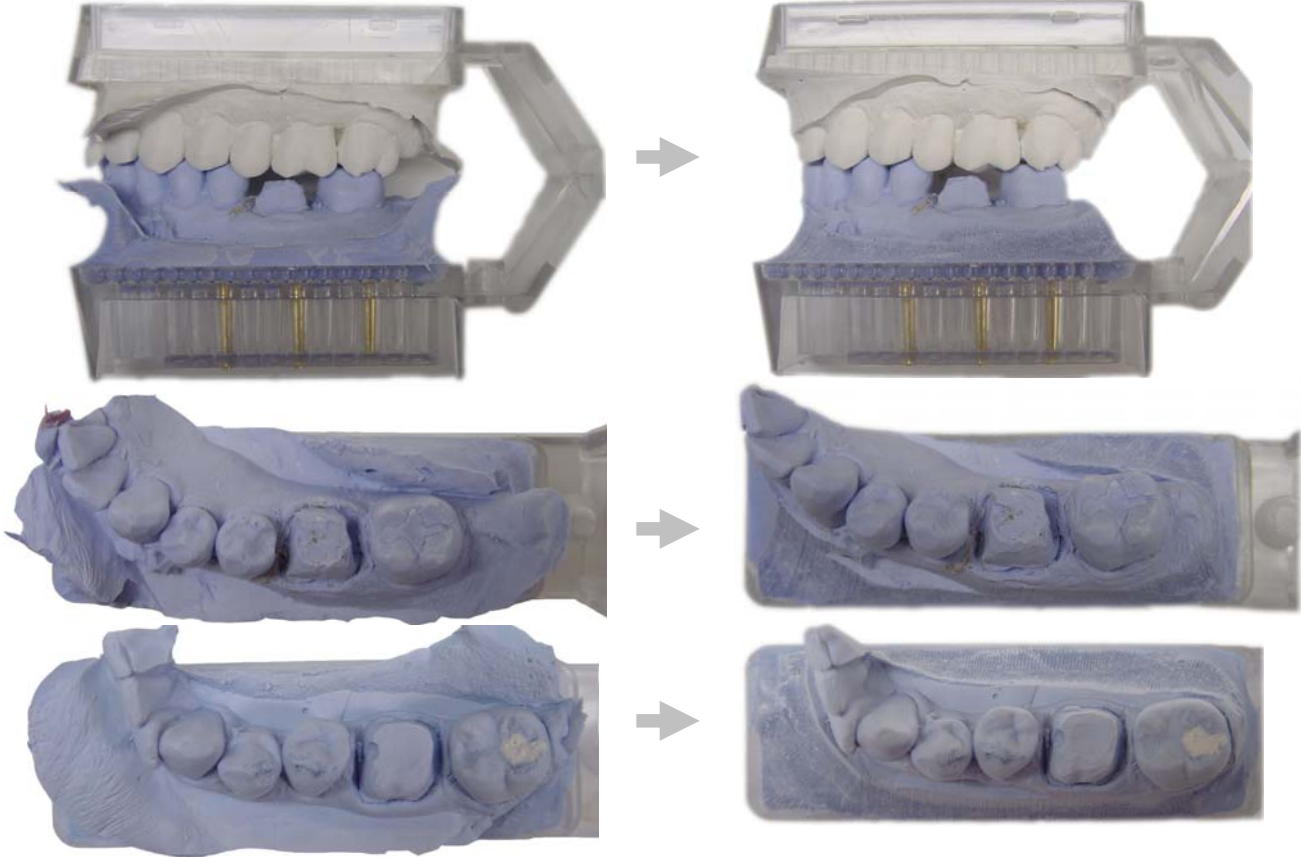

Grinding model directly on the tray

Full Arch

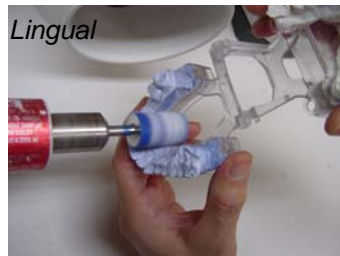
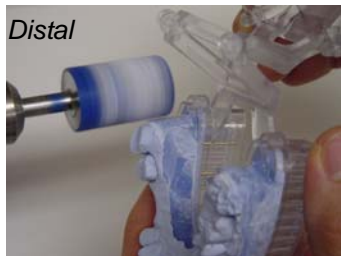
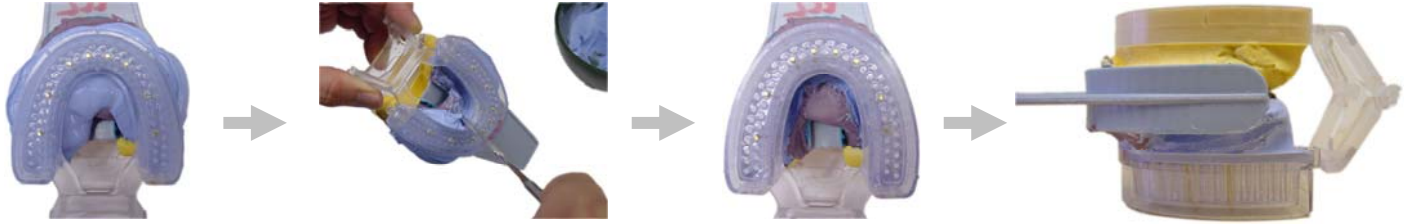

When grinding the buccal side, we recommend grinding in a downward motion rather than across the arch. Grinding across the arch will usually wear away the plastic and leave scuff marks.